

图 例

Description-Figure

安装尺寸图

Drawing

芯数
Contacts订货号
Ordering-NO

直式电缆母插头

Straight female plug

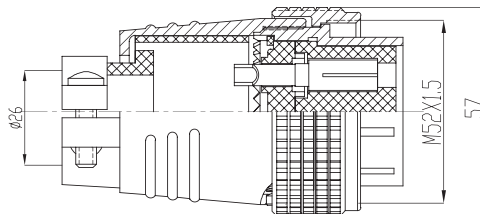

方形公插座

Square male socket

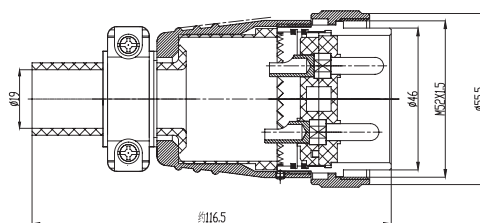
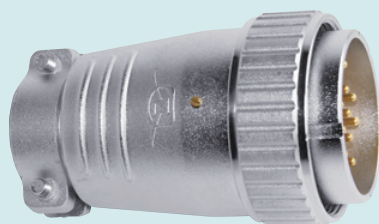
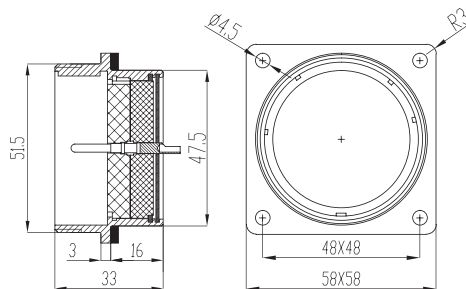



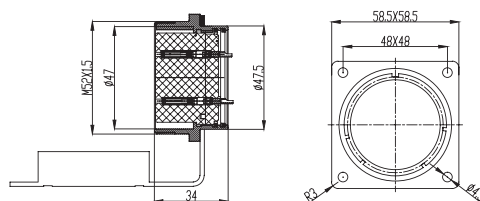

方形母插座

Square female socket

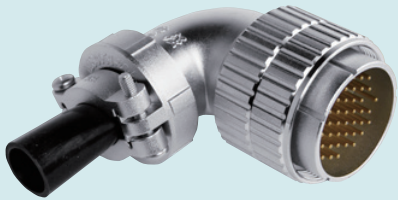
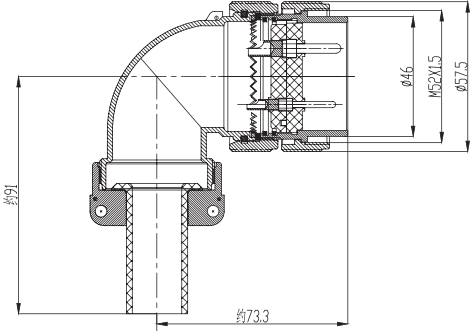

3	P48-3A
4	P48-4A
5	P48-5A
6	P48-6A
7	P48-7A
10	P48-10A
12	P48-12A
17	P48-17A
20	P48-20A
25	P48-25A
27	P48-27A
31	P48-31A
35	P48-35A
38	P48-38A
42	P48-42A
48	P48-48A
3	P48-3B
4	P48-4B
5	P48-5B
6	P48-6B
7	P48-7B
10	P48-10B
12	P48-12B
17	P48-17B
20	P48-20B
25	P48-25B
27	P48-27B
31	P48-31B
35	P48-35B
38	P48-38B
42	P48-42B
48	P48-48B
3	P48F-3A
4	P48F-4A
5	P48F-5A
6	P48F-6A
7	P48F-7A
10	P48F-10A
12	P48F-12A
17	P48F-17A
20	P48F-20A
25	P48F-25A
27	P48F-27A
31	P48F-31A
35	P48F-35A
38	P48F-38A
42	P48F-42A
48	P48F-48A
3	P48F-3B
4	P48F-4B
5	P48F-5B
6	P48F-6B
7	P48F-7B
10	P48F-10B
12	P48F-12B
17	P48F-17B
20	P48F-20B
25	P48F-25B
27	P48F-27B
31	P48F-31B
35	P48F-35B
38	P48F-38B
42	P48F-42B
48	P48F-48B

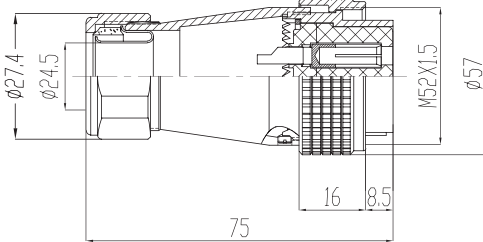
Page.87

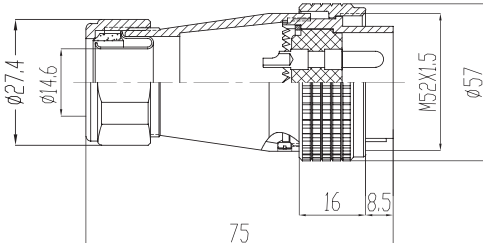
图 例 Description-Figure	安装尺寸图 Drawing	芯数 Contacts	订货号 Ordering-NO
90° 电缆公插头 90° angled male cable plug IP55 		3	P48F-3D
		4	P48F-4D
		5	P48F-5D
		6	P48F-6D
		7	P48F-7D
		10	P48F-10D
		12	P48F-12D
		17	P48F-17D
		20	P48F-20D
		25	P48F-25D
		27	P48F-27D
		31	P48F-31D
		35	P48F-35D
		38	P48F-38D
		42	P48F-42D
		48	P48F-48D
3/4" 金属软管母插头 3/4" metal hose female plug IP55 		3	P48-3A-3/4"
		4	P48-4A-3/4"
		5	P48-5A-3/4"
		6	P48-6A-3/4"
		7	P48-7A-3/4"
		10	P48-10A-3/4"
		12	P48-12A-3/4"
		17	P48-17A-3/4"
		20	P48-20A-3/4"
		25	P48-25A-3/4"
		27	P48-27A-3/4"
		31	P48-31A-3/4"
		35	P48-35A-3/4"
		38	P48-38A-3/4"
		42	P48-42A-3/4"
		48	P48-48A-3/4"
3/4" 金属软管公插头 3/4" metal hose male plug IP55 		3	P48F-3A-3/4"
		4	P48F-4A-3/4"
		5	P48F-5A-3/4"
		6	P48F-6A-3/4"
		7	P48F-7A-3/4"
		10	P48F-10A-3/4"
		12	P48F-12A-3/4"
		17	P48F-17A-3/4"
		20	P48F-20A-3/4"
		25	P48F-25A-3/4"
		27	P48F-27A-3/4"
		31	P48F-31A-3/4"
		35	P48F-35A-3/4"
		38	P48F-38A-3/4"
		42	P48F-42A-3/4"
		48	P48F-48A-3/4"

孔位排列 (从针的方向看)

The hole place arranges(Comply with the needle direction)

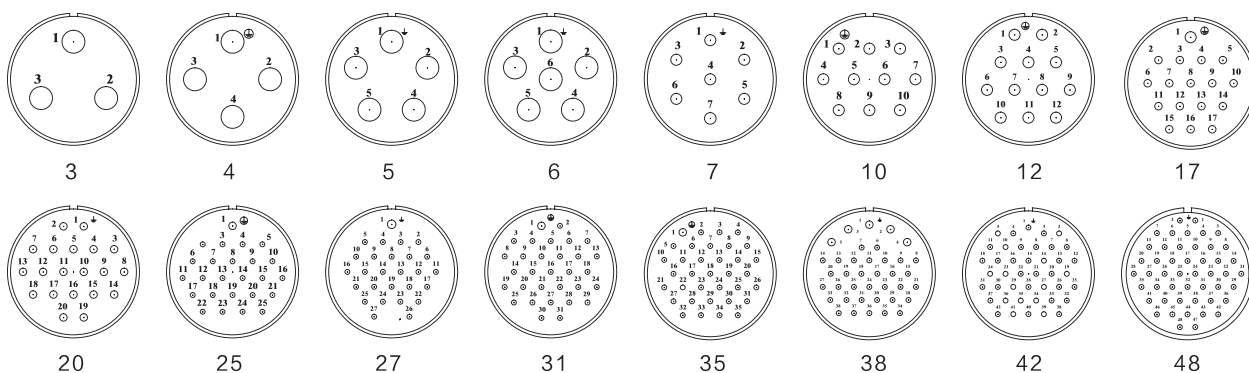

材料和技术方式

Material and specifications

接插方式 Coupling	螺纹连接 Threaded coupling	接线方式 Termination	焊接 Solder
外壳材料 Shell material	锌基合金 (镀铬) Zinc alloy with chromplate	接插次数 Mating cycle	500 次 500
绝缘体 Insert material	PC 料 PC	温度范围 Temperature range	-40℃ ~ +125℃
接触体材料 Contact material	铜 (镀银 / 金) copper(silverplated/gold)	电缆直径 Cable diameter	≤ φ 26mm
		防护等级 Protecting degree	IP55

技术参数

Technology parameter

芯 数 NO.of contacts	3	4	5	6	7	10	12	17	20	25	27	31	35	38	42	48
额定电流 / 电压 Rated current/voltage	80A/380V	80A/380V	70A/380V	50A/380V	35A/250V	25A/250V	25A/250V	20A/250V	20A/125V	20A/200V 10A/125V	20A/200V 10A/125V	20A/200V 10A/125V	20A/200V 10A/125V	20A/200V 7A/125V	10A/125V	10A/125V
工作电压 (AC.V) 分钟 Operation limit voltage(AC.V.rms)	500	500	500	500	380	380	380	380	250	200	200	200	200	200	200	200
耐电压 (AC.V) 分钟 Withstanding voltage(AC.V.rms) 1 minute	2000	2000	2000	2000	2000	2000	2000	2000	2000	2000	2000	2000	2000	2000	2000	2000
绝缘阻抗 (MΩ) DC500V Insulation resistance(MΩ MIN.) at DC 500V	2000	2000	2000	2000	2000	2000	2000	2000	2000	2000	2000	2000	2000	2000	2000	2000
接触阻抗 (mΩ) DC1A Contact resistance (mΩ MAX.) AT DC 1A	0.3	0.3	0.3	0.3	0.5	0.5	0.5	0.5	1	1 2.5	1 2.5	1 2.5	1 2.5	1 2.5	2.5	2.5
焊杯口径 φ (mm) Solder cup mouth aperture	5.0	5.0	5.0	5.0	5.0	5.0	5.0	5.0	3.0	3.0 1.5	3.0 1.5	3.0 1.5	3.0 1.5	3.0 1.5	1.5	1.5
接触体孔径 φ (mm) Solder inter diameter	5.5	5.5	5.5	5.5	3.6	3.6	3.6	3.6	2.4	1-2.4 1.6	1-2.4 1.6	1-2.4 1.6	1-2.4 1.6	1-2.4 1.6	1.6	1.6